

STANDARDS

- ANSI B16.34 and/or API 6A wall thickness and bolt loading

J Flow Controls 9300 Series In-Line Choke Valves

FEATURES & BENEFITS

- Machined from forging
- Pressure ratings up to 3,705 psi MOP
- Xylan® coated 17-4 Stainless Steel stem and disc driver
- Standard materials of API 4130 (75K) and 316SS or customer-specified materials
- Manual, electric, hydraulic or pneumatic actuation
- Open/close or modulating service
- Automated valves have selectable failure position
- Raised face flange connection

APPLICATIONS & INDUSTRIES

- Used to control the flow on production, re injection and wellheads
- Oil and gas production wells
- Liquid lines operating at very high pressures

9300 Series Choke Valves

Overview

Choke valves are severe service valves which are designed specifically for oil and gas wellhead applications, both in a surface and subsurface context. They are used for controlling the flow on production, re injection and subsurface wellheads.

A choke valve is sometimes installed in the carburetor of internal combustion engines. Its purpose is to restrict the flow of air, thereby enriching the fuel-air mixture while starting the engine.

Choke valve, sometimes also known as 'choker valve' is a type of control valve, mostly used in oil and gas production wells to control the flow of well fluids being produced. Another purpose that choke valves serve is to kill the pressure from reservoir and to regulate the downstream in the flowlines. Regulating choke valve is an automatic valve and valve opening can be controlled via electric or pneumatic signal from the control panel to regulate the flow in downstream flowlines.

Dimensions & Bill of Materials

3" 9300 Series

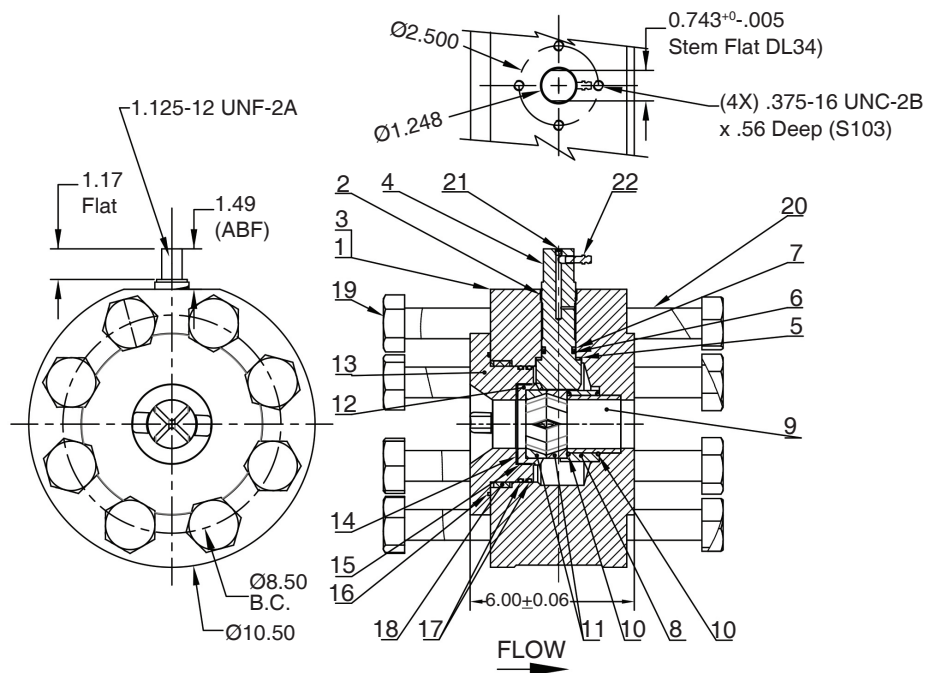

Est. Weight: 139 lbs

No.	Part Name	Qty	Material
1	Body	1	316SS
2	Sleeve Bearing	1	Delrin
3	Dowel Pin 1/4Øx1/2Lg.	2	-
4	Stem	1	17-4 HH1150
5	Thrustwasher	1	Delrin/PEEK
6	Seal	1	Field Lubricated High Pressure HNBR
7	Backup Ring	1	-
8	Wearsleeve	1	Tungsten Carbide Lined 17-4 H900 SS
9	Discharge Sleeve	1	-
10	O-Ring	2	HNBR
11	Disc, Control	2	Tungsten Carbide/ Cobalt
12	Driver	1	17-4 HH1150
13	Retainer, Control Valve	1	-
14	Thrustwasher	1	-
15	Sleeve	1	-
16	O-Ring	1	HNBR
17	O-Ring	2	HNBR
18	Backup Ring	1	-
19	Bolt HH 1.125-7 x 4.25Lg	8	B8M
20	Bolt HH 1.125-7 x 3.75Lg	8	B8M
21	Set Screw .25-28 x .25Lg	1	B8M
22	Grease Zerk 1/4 NPT	1	-

9300 Series Choke Valves

Dimensions & Bill of Materials

4" 9300 Series

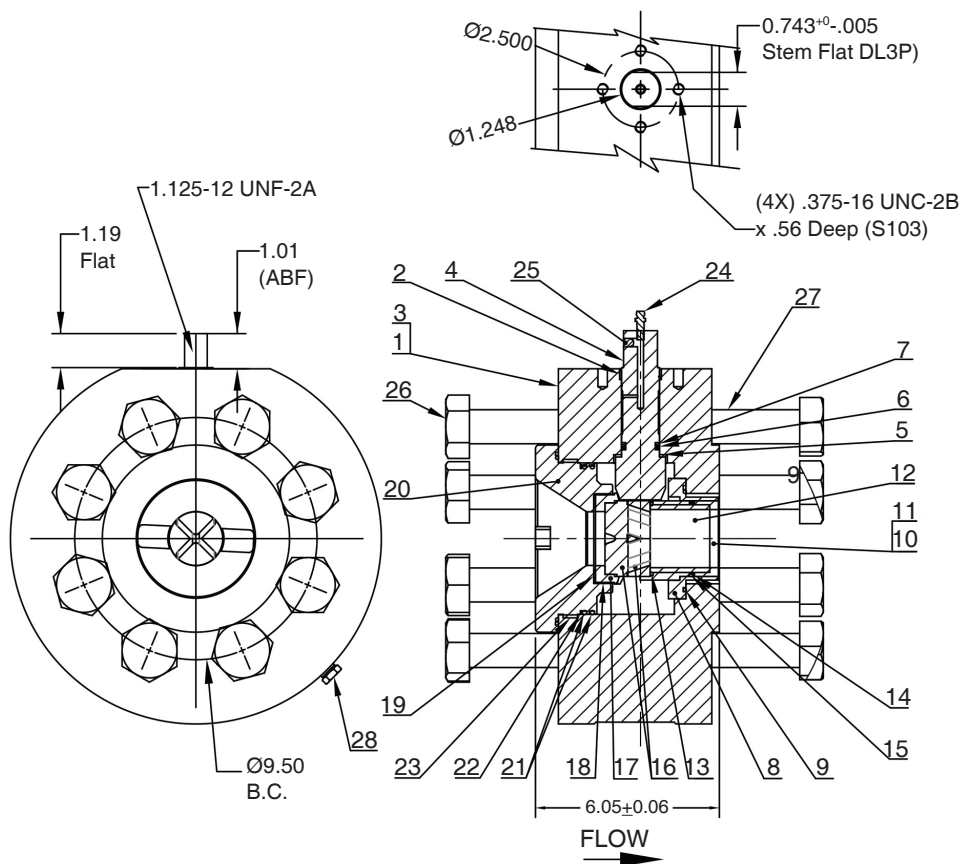

Est. Weight: 186 lbs

No.	Part Name	Qty	Material
1	Body	1	316SS
2	Sleeve Bearing	1	Delrin
3	Dowel Pin 1/4Øx1/2Lg.	4	-
4	Stem	1	17-4 HH1150
5	Thrustwasher	1	Delrin/PEEK
6	Seal	1	Field Lubricated High Pressure HNBR
7	Backup Ring	1	-
8	Wearsleeve	1	Tungsten Carbide Lined 17-4 H900 SS
9	O-Ring	2	HNBR
10	Wearsleeve		Tungsten Carbide Lined 17-4 H900 SS
11	Dowel Pin 1/4Øx3/8Lg.	2	-
12	Discharge Sleeve	1	-
13	O-Ring	1	HNBR
14	O-Ring	1	HNBR
15	Backup Ring	1	-
16	Disc, Control	2	Tungsten Carbide/ Cobalt
17	Driver	1	17-4 HH1150SS
18	Sleeve	1	-
19	Thrustwasher	1	-
20	Retainer, Control Valve	1	-
21	O-Ring	2	-
22	Backup Ring	1	-
23	O-Ring	1	HNBR
24	Grease Zerk	1	-
25	Set Screw .25-28 x .25Lg	1	B8M
26	Bolt HH 1.125-7 x 4.75Lg	8	B8M
27	Bolt HH 1.125-7 x 4.25Lg	8	B8M
28	Plug 1/4" NPT	1	-



4665 Interstate Drive
Cincinnati, OH 45246

513-731-2900
JFlowControls.com