



JFLOWM
CONTROLS[®]



**JFDG-SD Series
Declutchable Wormgear
Manual Override**

The JFDG series are rugged, industrial grade manual overrides, manufactured with analuminum housing. All models in this series feature high performance bearings and a polyurethane coated finish.

Applications

The JFDG series is designed to provide a manual operation of 90° for valves which are equipped with a J flow Controls pneumatic rack & pinion actuator.

The JFDG series is providing a declutchable design for use in all Industries where a reliable operation of both double acting and spring return pneumatic actuators are required.

All units which are to be mounted between the valve and actuator will be supplied with a (interchangeable) actuator mounting flange for flexible usage. Furthermore, all units can be supplied with the ISO drive shaft which is connecting the actuator with the valve.

Optionally, a block & bleed relief valve can be fitted onto the actuator in order to evacuate air pressure from the actuator prior to engaging the manual override.

- Performance specifications**

7 Models-->Torque range up to 33600 In-Lbs.

Adjustable stroke from -5° to +95°

Housing rating to IP68 sealing

Temperature range -25 °C to +110 °C (-13 °F to +230 °F)



Model #	J Flow Double Acting Actuator Model#	J Flow Spring Return Actuator Model#	Mech Advantage Ratio	Max Output Torque In-Lbs
JFDG-SD1-14-180	JFC050D-JFC095D	JFC050S-JFC085S	26:1	700
JFDG-SD2-17-200	JFC110D-JFC125D	JFC095S-JFC110S	28:1	2800
JFDG-SD3-22-280	JFC25D-JFC140D	JFC125S	38:1	6000
JFDG-SD4-27-300	JFC160D-JFC190D	JFC140S-JFC160S	54:1	10600
JFDG-SD5-36-400	JFC210D-JFC240D	JFC190S-JFC210S	80:1	18500
JFDG-SD6-46-500	JFC240D-JFC270D	JFC210S-JFC240S	78:1	26500
JFDG-SD7-46-600	JFC270D-JFC300D	JFC240S-JFC270S	98:1	33600

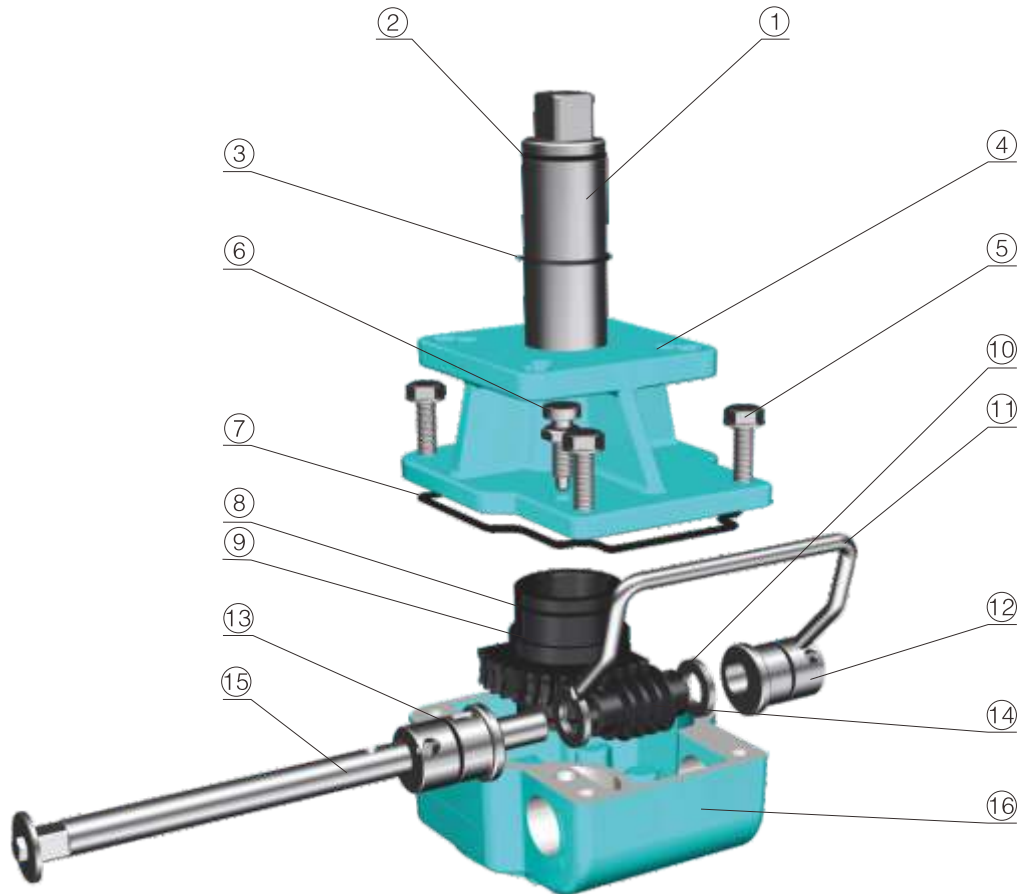

● Main components and materials

No.	Name	Material	No.	Name	Material
1	Drive spindle	Alloy steel	9	Worm gear	Spheroidal graphite cast iron
2	Seal ring	Nitrile rubber	10	Plane bearing	Alloy steel
3	Reed spring	Stainless steel(304)	11	Handle	Stainless steel(304)
4	Upper cover	Aluminium alloy	12	Eccentric sleeve	Alloy steel
5	A fastening	Stainless steel(304)	13	Seal ring	Nitrile rubber
6	Positioning pin	Alloy steel	14	Worm	Alloy steel
7	Seal ring	Nitrile rubber	15	Transmission rod	Alloy steel
8	Seal ring	Nitrile rubber	16	Box	Aluminium alloy

JFDG-SD1 THRU JFDG -SD6

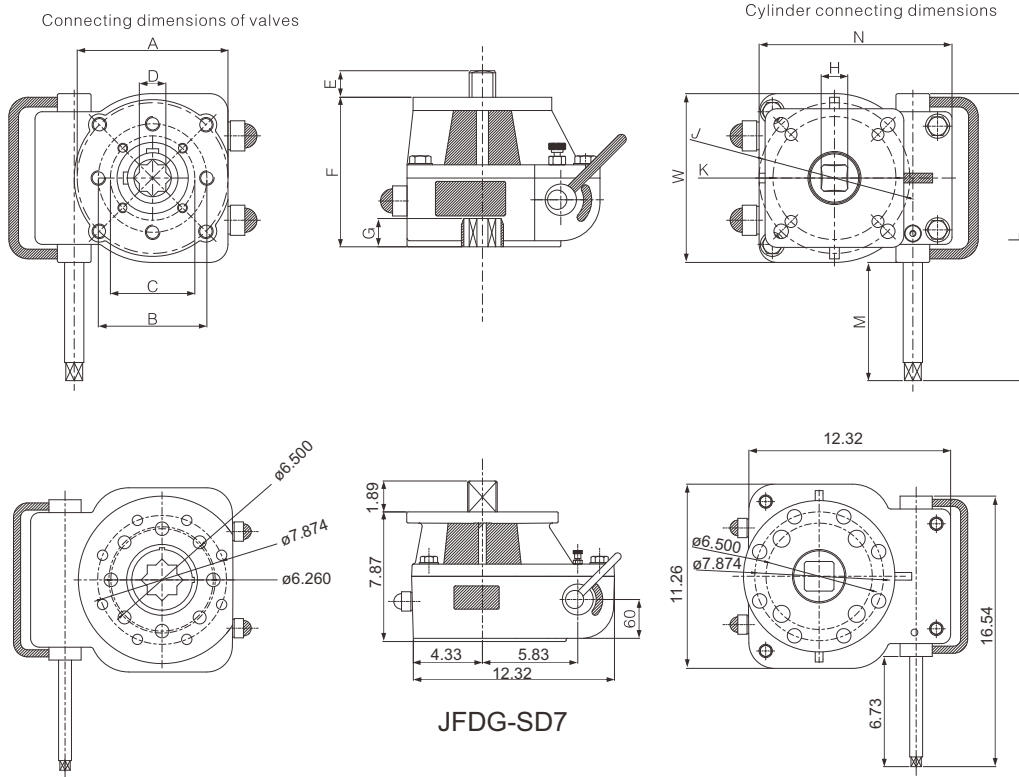

● JFDG-SD Series Dimensions (Inch)

Specification model	JFDG-SD1	JFDG-SD2	JFDG-SD3	JFDG-SD4	JFDG-SD5	JFDG-SD6	JFDG-SD7
MOUNTING PAD DIMENSIONS - VALVE SIDE							
A	F07	F10	F12	F14	F16	F16	F16
B	ø2.25	ø2.75	ø3.50	ø4.25	ø4.25	ø6.25	ø6.25
C	F05	F07	F07/F10	F10/F12	F14	F14	Φ 200
D	0.554 (14MM)	0.669 (17MM)	0.866 (22MM)	1.063 (27MM)	1.417 (36MM)	1.811 (46MM)	1.811 (46MM)
E	0.59	0.75	0.87	1.10	1.50	1.88	1.88
F	4.13	4.33	5.12	6.50	7.28	7.87	7.87
G	0.79	0.87	1.10	1.26	1.57	1.97	1.97
H	0.554 (14MM)	0.669 (17MM)	0.866 (22MM)	1.063 (27MM)	1.417 (36MM)	1.811 (46MM)	1.811 (46MM)
N	4.53	5.32	6.30	7.87	9.61	11.10	12.32
W	3.52	4.92	5.35	7.38	8.66	9.88	11.26
MOUNTING PAD DIMENSIONS - ACTUATOR SIDE							
J	F07	F10	F12	F14	F16	F16	F16
K	F05	F07	F10	F10/F12	F14	/	Φ 200
L	7.09	8.66	10.12	12.99	14.57	15.75	16.54
M	2.80	3.63	4.45	5.82	5.83	6.22	6.73
Hand wheel outer diameter	ø7.0 (180MM)	ø7.9 (200MM)	ø11.0 (280MM)	ø12.6 (320MM)	ø15.8 (400MM)	ø19.7 (500MM)	ø23.6 (600MM)
WEIGHT (lbs)	7	10	15	30	48	66	84