

STANDARDS

- Waster and sewage systems

J Flow Controls 1000 Series Eccentric Plug Valve

FEATURES & BENEFITS

- Mainly used in water supply and sewage systems
- Zero leakage
- Moisture-proof damage
- Maintenance free
- High service life

APPLICATIONS & INDUSTRIES

- Sewage
- Raw water
- Fresh water
- Sea water

PRODUCT STRUCTURE & FEATURES



VALVE FULLY OPEN

Plug is hidden in the body to avoid flushing



VALVE CLOSING



VALVE CLOSING

The valve can be opened and closed by turning the spool to 90 degrees. Integral ductile iron plugs increase the strength of the plugs and ensure accuracy of plug mounting position correction. When the valve opens, the plug rotates to the side of the body cavity, avoiding the flow direction of the fluid in the channel, which can further avoid the impact and damage of the fluid on the plug in use, and extend the service life. The rubber sealing surface of the all-wrapped rubber plug can achieve tight seal and zero leakage. Rotary valve within the working pressure range can achieve two-way zero leakage.



Fluid by circular cross section in the valve, the square runner. In the process of round become square, flow experience have organized the eddy current scour sealing surface, avoiding sealing surface accumulation and clamp dirt, preventing the sealing surface fouling. When there is a massive dirt accumulation in the body, the sewage can be pushed out when the valve is closed. When there is a small dirt attached to the seal on the cover, the valve closing rubber can handle the accumulation and it does not affect the sealing surface. When the valve opens, the dirt is washed away.

Full port design, no port shrinking, low head loss.

Full top opening bonnet. At the end of valve life, simply replace the valve cover to complete the dismantling of the valve.

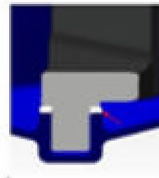

PRODUCT STRUCTURE & FEATURES

Long service life and no maintenance. Sealing surface adopts 95% nickel of 316SS stainless steel welding process, seat and valve as a whole, can effectively prevent the rubber sealing surface of plug valve from being damaged by medium corrosion. A raised sealing surface ensures that the rubber plug is only in contact with stainless steel or nickel, greatly increasing the life of the rubber.

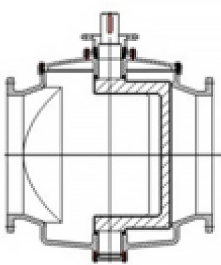
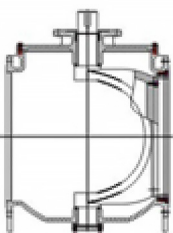

Gravel pad protection by reducing the contact with the fluid in the debris to increase the service life of packing and sleeve jacket.

Rubber encapsulated spool does not rust.

	PLUG VALVE	HALF BALL VALVE	BUTTEFLY VALVE	GATE VALVE
SPACE				
TURNS	136	175	78	562
PORT AREA	100%	Because of construction, could not meet full port	Disc takes space of the port area	100%
DIRECT PROTECTION	Best	Good	Worse	Worst
LIFE IN WASTEWATER	12 years. After replace the plug, extend life to 24 years	3 - 8 years. Cannot not 100% seal after replacing rotator	1 - 5 years, can not be fixed in line	5 - 8 years
SEAL IN WASTEWATER	Single direction, zero leakage, back flow leakage less than 0.5 mPa	Single direction seal	Single direction flow	Can not assure seal

1000 Series Eccentric Plug Valve

DIMENSIONS

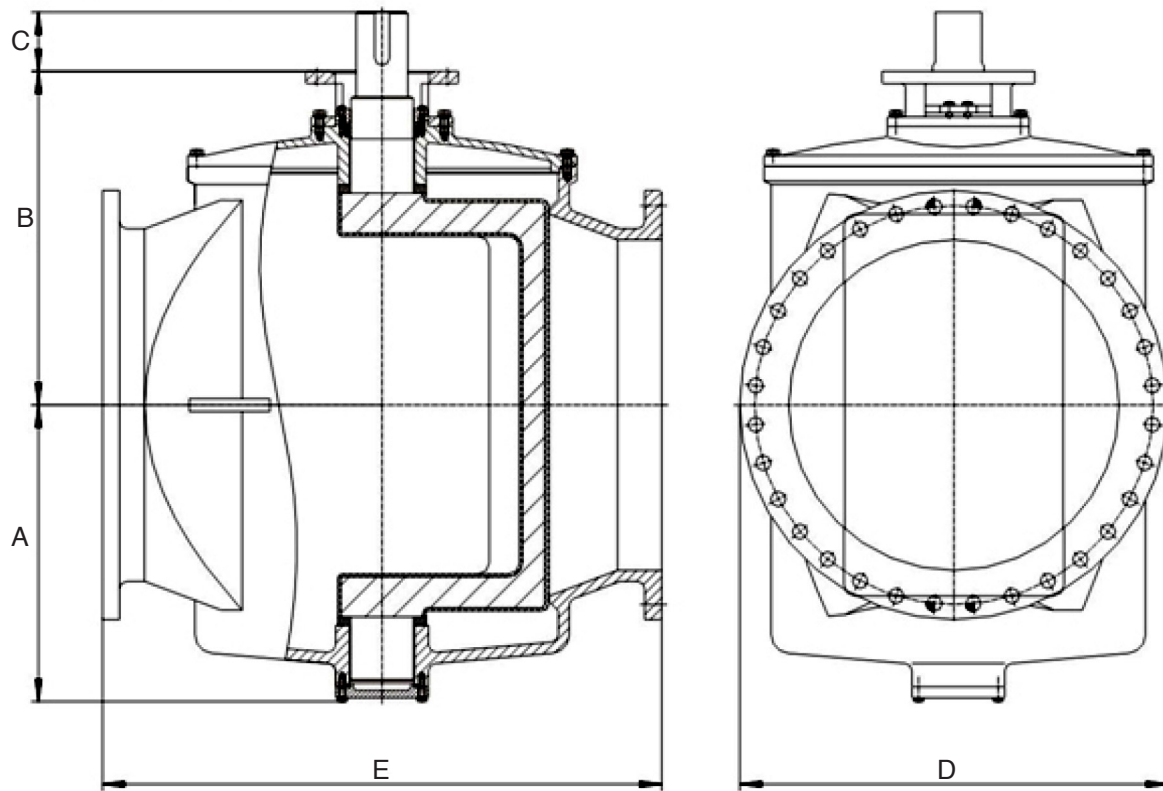

1000 Series Eccentric Plug Valve

INSTALLATION DIMENSIONS

Size	A	B	C	D	E
4"	5.24	7.40	1.57	8.66	8.98
6"	6.30	8.43	1.57	11.2	10.5
8"	8.07	10.6	1.97	13.4	11.5
10"	9.25	11.6	1.97	15.6	13.0
12"	11.3	14.3	2.17	17.5	14.0
14"	12.8	15.2	2.17	20	17.0
16"	15.7	18.3	2.36	22	17.7
18"	16.5	19.1	2.36	24	22
20"	17.7	21.2	2.36	26	24
22"	21.5	26	2.95	31	42
24"	25	30	2.95	40	51
26"	32	36	3.34	44	60
28"	35	38	3.94	48	72
30"	38	42	4.72	57	84
32"	40	50	5.91	66	91
34"	47	56	7.09	75	95
36"	53	69	7.87	83	113
38"	58	78	7.87	89	126

BILL OF MATERIALS

PART NAME
Body
Valve Core
Valve Deck
Bearing
Backup Ring
Packing
Shaft Sleeve
Packing Gland
Standard Component



4665 Interstate Drive
Cincinnati, OH 45246

513-731-2900
JFlowControls.com