



DESCRIPTION

- 3-Way Ball Valve
- Direct Mount
- Full or Reduced Port
- 1/4" - 2"
- 800 PSI (WOG)

DM51(2)00 Series

CERTIFICATIONS

- Valve Design: ASME B16.34
- Material Certification: EN10204-3.1 MTR
- Quality Assurance: ISO 9001:2008
- Steel Casting: MSS SP-55
- Valve Marking: MSS SP-25
- Valve Test: API 598
- Direct Mount: ISO 5211
- Stem Connection: DIN 3337
- Anti-Static: API 608
- Sulfide Stress Cracking: NACE MR-01-75
- End Connections: ASME B16.11, ASME B1.20.1, ASME B16.25

FEATURES AND BENEFITS

- Body and End Caps Quality Investment Casting
- Available in Stainless Steel or Carbon Steel
- With ISO 5211 Direct Mounting Pad
- Adjustable Stem Packing
- Blow-Out Proof Stem Design
- Available in L / T Port
- Available in Full or Reduced Bore
- 100% Air Tested Under Water at 80-100 psi
- Temperature Range from -20°F to 600°F
- End Type: NPT
- With Real Locking Function

OPTIONS

- Automation Application
- 180° Operation
- PTFE / RPTFE / TFM1600 / TFM4215

FULL PORT VALVE
FLOW COEFFICIENT

ITEM SIZE	3-Way L-Port Full Bore	3-Way T-Port Full Bore
1/4"	7	15
3/8"	7	15
1/2"	13	25
3/4"	23	46
1"	35	70
1-1/4"	54	109
1-1/2"	81	162
2"	153	309

BREAK-TORQUE VALUE (in-lb at 0 psi)

SIZE (FULL BORE)	1/4"	3/8"	1/2"	3/4"	1"	1-1/4"	1-1/2"	2"
SIZE (RED. BORE)	-	1/2"	3/4"	1"	1-1/4"	1-1/2"	2"	-
GREASE	9	9	11	13	24	43	53	60
NON-GREASE	12	12	15	18	33	60	75	84

Note 1: The greases J Flow Controls uses include lubricants and anti-seize grease that are both SILICONE-FREE.

Note 2: J Flow Controls strongly suggests increasing the torque at least 30%-40% for safety factor when mounting an actuator.

DM51(2)00 Series Valves

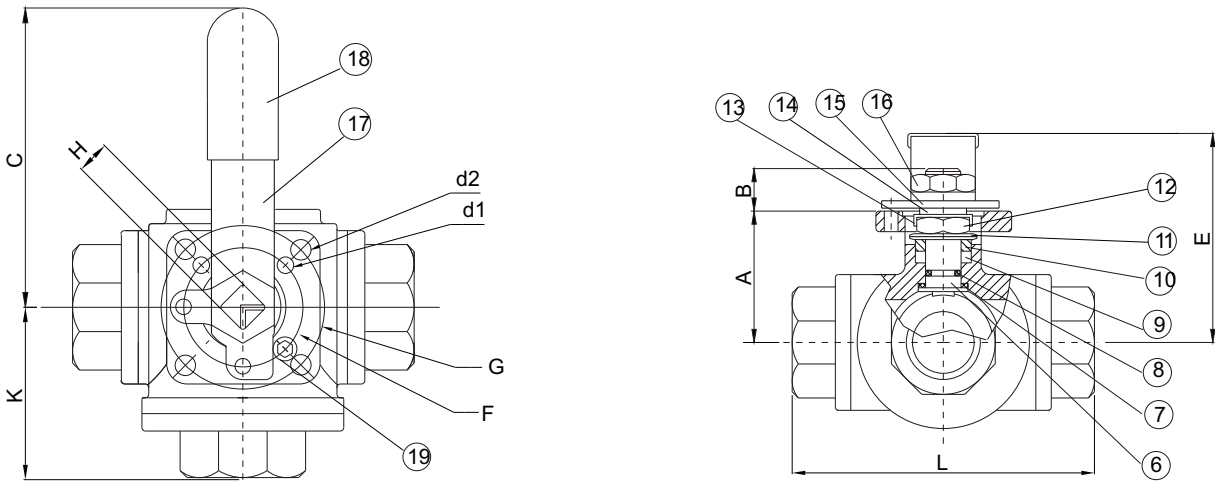

DIMENSIONS (in)

FULL PORT	RED. PORT	A	B	C	d1	d2	E	F	G	H	K	L	Port
1/4"	-	1.46	0.37	5.12	0.24	0.24	2.44	1.42	1.65	0.35	1.38	2.83	0.43
3/8"	1/2"	1.46	0.37	5.12	0.24	0.24	2.44	1.42	1.65	0.35	1.38	2.83	0.47
1/2"	3/4"	1.65	0.43	5.12	0.24	0.24	2.52	1.42	1.65	0.35	1.59	3.33	0.59
3/4"	1"	1.93	0.55	6.50	0.24	0.28	3.23	1.65	1.97	0.43	1.95	3.94	0.79
1"	1-1/4"	2.17	0.55	6.50	0.24	0.28	3.50	1.65	1.97	0.43	2.22	4.45	0.98
1-1/4"	1-1/2"	2.48	0.67	8.07	0.28	0.36	3.86	1.97	2.76	0.55	2.44	4.94	1.26
1-1/2"	2"	2.91	0.63	8.07	0.28	0.36	4.25	1.97	2.76	0.55	2.89	5.91	1.50
2"	-	3.62	0.83	12.80	0.36	0.45	5.51	2.76	4.02	0.67	3.43	6.85	1.97

PRESSURE/TEMPERATURE CHART

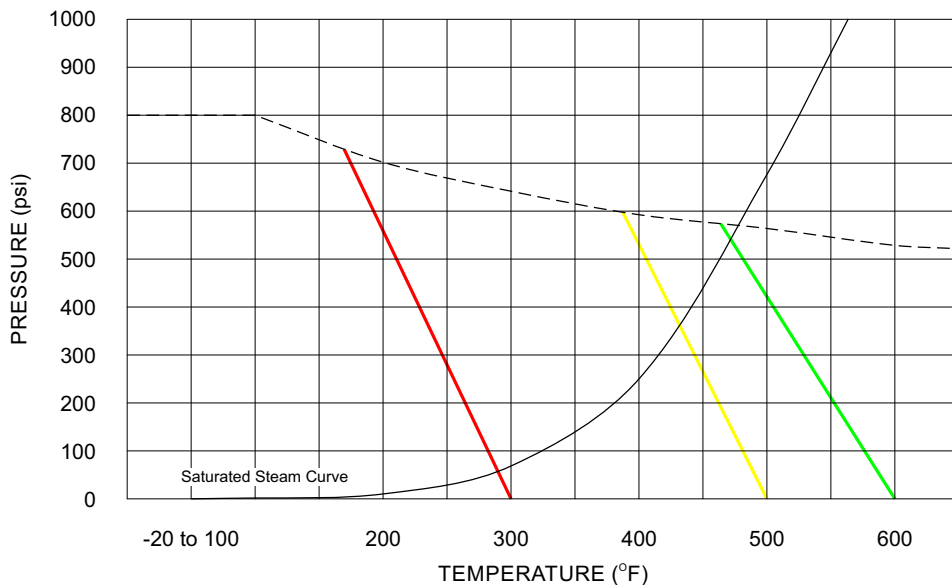

■ PTFE
 ■ TFM1600
 ■ TFM4215

DM51(2)00 Series Valves

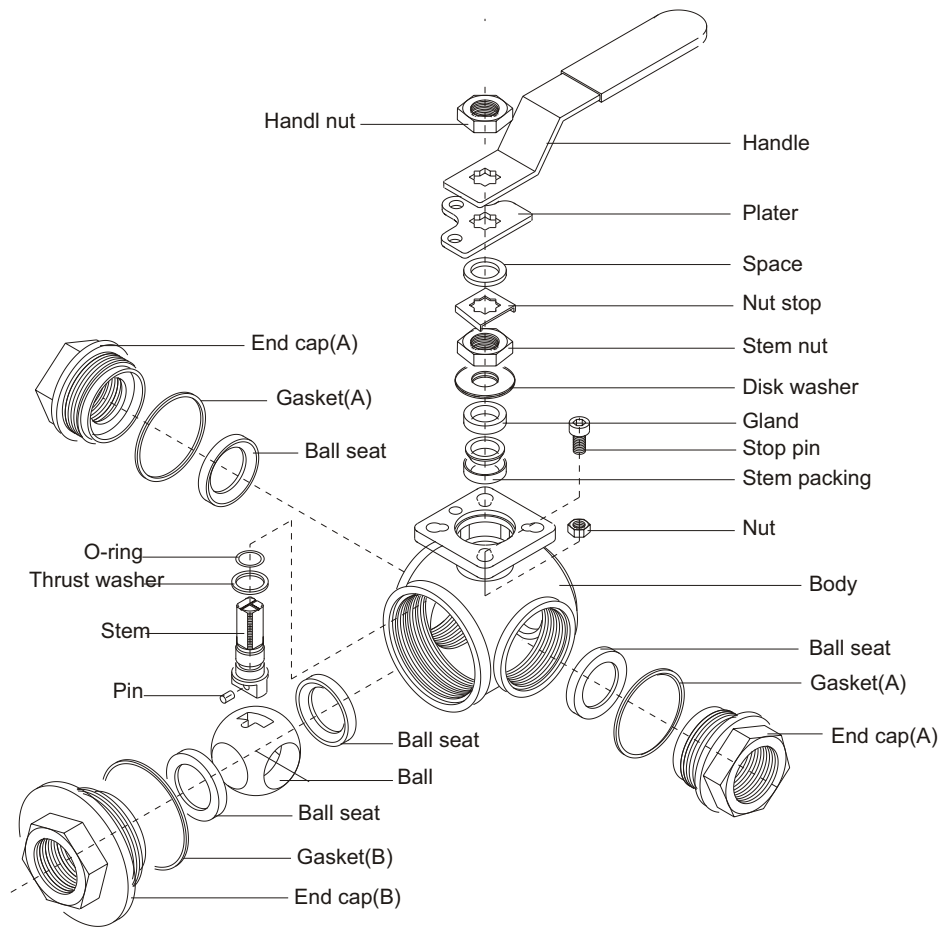

MATERIALS LIST

ITEM	PART NAME	MATERIALS
1	END CAP	CF8M
2	GASKET	PTFE
3	BODY	CF8M
4	BALL	SS 316
5	SEAT	PTFE
6	STEM	SS 316
7	THRUST WASHER	RPTFE
8	O-RING	VITON
9	STEM PACKING	PTFE
10	GLAND	SS 304
11	DISK WASHER	SS 301
12	STEM NUT	SS 304
13	NUT STOP	SS 304
14	SPACE WASHER	SS 304
15	STOPPER PLATE	SS 304
16	HANDLE NUT	SS 304
17	HANDLE	SS 304
18	SLEEVE	PLASTIC
19	STOP PIN	SS 304

DM51(2)00 Series Valves

HOW TO ORDER

Example: 100-DM5133FPTTTTFTNANA

VALVE SIZE				PRODUCT SERIES	BODY MATERIAL		BALL/STEM MATERIAL		PORT		PACKING / BODY SEAL MATERIAL	
050	1/2"	125	1-1/4"	DM51	2	WCB	3	CF8M	FP	Full Port	TM	TFM1600
075	3/4"	150	1-1/2"	DM52	3	CF8M			RP	Reduced Port	TC	TFM4215
100	1"	200	2"									

SEAT MATERIAL		END CONNECTIONS		MATERIAL OPTIONS		DESIGN OPTIONS	
TM	TFM1600	F15	ANSI 150 RF Flange	NA	Standard	NA	Standard
TC	TFM4215	F30	ANSI 300 RF Flange			L2	3-Way Port L2 - 90°
		SCW	Socket Weld			L3	3-Way Port L3 - 90°
		FPT	Female NPT			T3	3-Way Port T3 - 90°
		TRC	Tri-Clamp			T4	3-Way Port T4 - 90°
		FMT	Female Metric THD			T5	3-Way Port T5 - 90°
						T6	3-Way Port T6 - 90°

While the information and specifications contained in this literature are believed to be accurate, they are supplied for informative purposes only and should not be considered certified or a guarantee of satisfactory results. Nothing contained herein is to be construed as a warranty or guarantee, express or implied, regarding any matter with respect to this product. Because J Flow Controls is continually improving and upgrading its product design, the specifications, dimensions and information contained herein are subject to change without notice.